

Treonica Reboot User Guide (v2.11)

This software allows you to reset your device. When you hit the Reboot button, a reset will be initiated. By default this will be a SOFT RESET.

A SOFT RESET WILL NOT ERASE ANY APPLICATION DATA OR SYSTEM SETTINGS YOU HAVE FROM YOUR DEVICE.

For the Reboot button to work, the 'enable Reboot button' check box has to be ticked, (if present).



Normal Mode – the default



Advanced Mode ☺

The presence of the 'enable Reboot button' check box can be controlled through the Preferences screen:



This is checked by default.

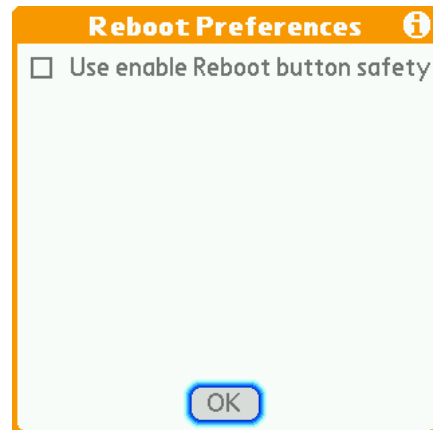

Advanced users can leave this unchecked, but the code doesn't know if you're advanced or basic - that's in the Professional Edition

A soft reset will reinitialise the dynamic heap on your device without touching any data in storage RAM and additionally empty the notification registry. Basically that's like yoga for your Treo; it's good for the health of the operating system, so reboot as often as you like!

If you want to do a system reset (also known as a *warm reset*), or even a hard reset, you can do so by following the instructions in your official Palm user manual on what buttons to press when the device is starting up (it varies slightly from device to device).

This software can't be run if your device has crashed and is therefore not a full substitute for a physical reset switch, but in all other circumstances it does allow you to reset your device without removing the battery cover and removing the battery, which is what you have to do on the Treo 680. The code wasn't designed to be able to get the device's attention if it's locked up – that's a job only hardware can do.

Palm handhelds (meaning non-Treo devices) always had a reset button that you could access on the back of the unit, but on the Treo they just didn't include it for some reason. According to the documentation on the Treo 650 you just have to remove the battery cover and can reset without taking out the battery, but it's still deficient compared to handhelds in this respect.

Device Compatibility

This software should work on any device running Palm OS 2.0 or later. It will work on any Palm Treo running Palm OS, including the latest device, which at the time of writing is the Palm Treo 755p. The Palm Centro runs Palm OS 5.4.9 so it will work for that too.

Minor Details

Note that depending on what you've got installed on your machine some third party applications may need to be reactivated after a soft reset, but most won't (including Treonica Auto v4.0 or later).

All forms are modal and you can use the 5-way rocker to navigate. A help summary is available on each screen if you hit 'i' in the top right hand corner.

Treonica Reboot is installed to the *Unfiled* category for you to put wherever you want.

In the Preferences screen you must hit OK to save any change to the check box. Some Palm applications consider hitting the App home button or switching to another app to be an OK, but this screen is coded so that means 'Cancel'.

In Palm OS, applications can save their user settings in a preferences database specifically for applications. There are two kinds of application preferences, 'saved' and 'unsaved'; confusing terminology because both are saved in storage memory. Saved application preferences can be restored back to your device after a hard reset, because the data is backed up during a HotSync. Unsaved application preferences are not backed up during a HotSync (by default). As Treonica Reboot only has one small preference, it uses application unsaved preferences. If you delete Treonica Reboot via the launcher App->Delete menu or any application for that matter, this will clear any application saved or application unsaved preferences from your device. If that sounds confusing, just forget about it – only trying to explain some Palm OS internals.

Understanding Palm Resets; Soft, System (Warm) and Hard

As mentioned above a soft reset reinitialises the dynamic heap on your device without touching any data in storage RAM and additionally empties the notification registry. That's the programmer's explanation, but most users only want to know that it's like telling your hardware to restart, like rebooting a PC.

A hard reset does a soft reset but also reinitialises your storage RAM. That's a severe thing to do because storage RAM is where all your installed applications, application databases, application preferences and system preferences live. A hard reset resets your device to its factory default condition.

In addition to soft and hard resets we also have system resets, which can be thought of as somewhere in between in terms of severity, but much closer to a soft reset than a hard reset in terms of similarity! A system reset is the same as a soft reset, but at start up Palm OS prevents automatically run (at start up) third party applications from being invoked, as an aid to problem solving. Note that a system reset is sometimes referred to as a *warm reset*.

The system reset facility is meant to allow users to regain their sanity in case their device goes into a reset loop. A reset loop is a condition where some software causes your device to crash and resets your device, but because that software is configured to start automatically when the device starts, after a crash that software is run again and so crashes the device again, resulting in a perpetual loop of crashing and restarting. So there you go, system resets allow you to break out of a bad situation like that.

The ability to cause a reset loop is not a great selling point for any software and is unlikely to be featured in its marketing!

Our software will not cause a reset loop or any involuntary reset.

License

This software is provided for registered users of Treonica Auto and is unlockable with the same license code (if it came bundled in the same zip file). It is also available separately.

Contact and Support Information

For questions, feedback or anything else please send email to: support@treonica.com

Alternatively, please use the web page: www.treonica.com/support

DISCLAIMER:

TREONICA MAKES NO WARRANTY, EXPRESS OR IMPLIED, AS TO THE ACCURACY, COMPLETENESS OR FUNCTIONING OF THE LICENSED SOFTWARE, INCLUDING WITHOUT LIMITATION, WARRANTIES OF MERCHANTABILITY OR OF FITNESS FOR A PARTICULAR PURPOSE, ALL OF WHICH TREONICA DISCLAIMS. ALL LIABILITY IS DISCLAIMED AND TREONICA ASSUMES NO RESPONSIBILITY OR LIABILITY FOR LOSS OR DAMAGES OF ANY KIND, DIRECT OR INDIRECT, INCIDENTAL, CONSEQUENTIAL OR SPECIAL, ARISING OUT OF YOUR USE OF THE LICENSED SOFTWARE, EVEN IF ADVISED OF THE POSSIBILITY THEREOF.